

LE MAJESTIC



CENTRE DE CONGRES

# SUMMARY

Description.....	page 3	Isabella Straton meeting room.....	page 15
Floor plan.....	page 4	Edgard Bouillette meeting room.....	page 16
Technical equipment & furniture.....	page 5	Gabriel Loppé meeting room.....	page 17
Videoconference equipment.....	page 7	Samivel meeting room.....	page 18
Coutterand lobby.....	page 8	Detailed floor plans.....	pages 19 - 29
Michel Payot meeting room.....	page 9		
Paul Payot meeting room.....	page 11		
Théodore Bourrit meeting room.....	page 12		
Joseph Vallot meeting room.....	page 13		
Jules Janssen meeting room.....	page 14		

# PRESENTATION

The Majestic Congress Centre is a public access area, based on the ground floor of LE MAJESTIC building, located **241 Allée du Majestic – 74400 Chamonix Mont-Blanc - France**.

The Majestic is a listed building « GHZ », 1st category. The whole meeting rooms located on the ground floor can hold up 1 000 people.

The venue offers 9 meeting rooms from 34 to 430 square meters, with communication doors inbetween 7 of them. The 2 last rooms are located in the common areas of the building.

These rules of procedures shall apply to all users of the congress centre.

# ROOM MAP

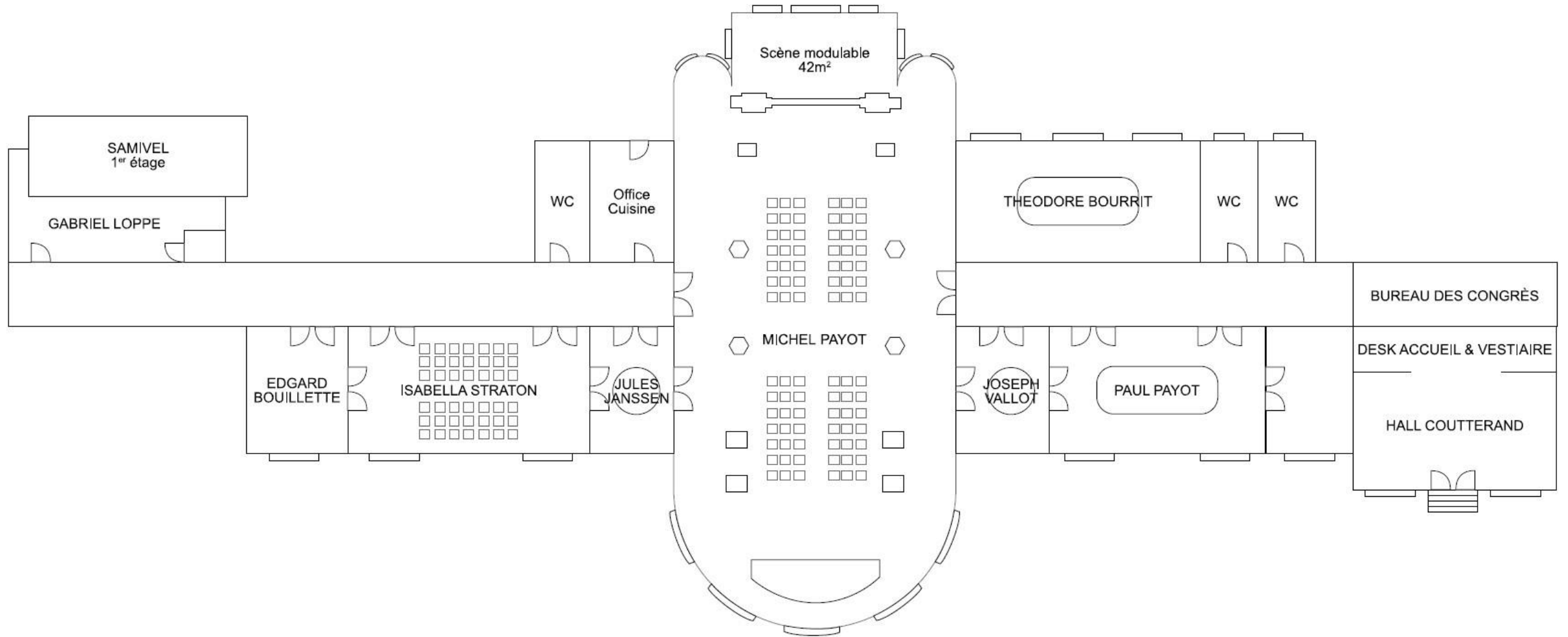

# TECHNICAL EQUIPMENT & FURNITURE

Here are technical equipment managed by the Majestic Congress Centre Staff. Some of them are included in cost rental, some others with extra costs :

## Internet

Wifi connection in whole meeting rooms via optical fiber (20Mo upload and download). On request :

- wire connection with personalised address
- higher speed (until 100 Mo upload and download) – *with extra cost.*

## Projection

3 screens 1.90 m x 2.00 m

2 screens 150 m x 150 m

1 screen 2.40 m x 1.80 m

6 beamers : 5 x 3000 lumens, 1 x 2000 lumens

1 LED screen 65 inches/165 cm SAMSUNG UHD QM65R-A

2 Plasma screens 50 inches/ 127 cm PANASONIC TH-50PF30EF on VOGEL feet

## Sound System

1 BOSCH CONFERENCE numeric System CCS-1000D – 29 individual micro conference stations, 1 « president » station

2 amplifiers mixing consoles EV DYNACORD PM100-2

1 CD player TECHNICA

1 SD Card recorder TASCAM DR-07

4 audio speakers RCF 5Art 312)

2 audio speakers ELECTROVOICE ZX1

5 microphones SHURE SM58

2 swan neck microphones SENNHEISER MZH 3040

1 handheld microphone / tie microphone HF SHURE ULX4

1 handheld microphone / headset microphone HF SHURE ULXP4

1 mobile Sound Machine (SM-22)

*1 mobile sound machine Mipro (MA 708), maintenance in order*

# TECHNICAL EQUIPMENT & FURNITURE

## **Videoconference Equipment**

- 1 mixer DATAVIDEO HS 1600T-MK2 (3 camera inputs, 1 HDMI input, 1 integrated output, recording)
- 3 turret cameras DATAVIDEO PTC 150 T, zoom 30x, full HD, with tripod
- 1 mixer Seamless Analog Way PULSE PLS 350H

## **Display**

- 11 flipcharts size 65 x 96 cm / 75 x 100 cm (paper roll 63.5 x 97.5 cm)
- 50 notice boards feutrine (operating face 90x180 cm)

## **Other equipments**

- Photocopier RICOH with counting sorter and USB connection
- Fax

## **Furniture**

- 500 chairs (45 x 60 x 92 cm)
- 30 round tables (160 cm diameter – max 9 chairs)
- 70 narrow tables (180 x 40 cm)
- 50 rectangular tables (120 x 80 cm)
- 12 large tables (200 x 120 cm) for large U shape meeting + 2 half-round tables (200 x 100 cm)
- 10 high-bar tables (84 cm diameter), black lycra cover
- 6 high stools (3 reds, 3 blacks)
- 8 red « toad » chairs
- 2 black low tables (60 cm high)
- 2 pedestal tables marble style (60 cm diameter – 73 cm high)
- 3 glass offices in the hall (75 cm high)
- 1 plexi lecturn 50 x 114 cm
- 1 marble style lecturn with headband (63 x 9 cm)

# VIDEOCONFERENCE EQUIPMENT

Portable & compact 4-channel HDBaseT Switcher

- Built-in H.264 Recording to SD card
- Single Cat6 cable provides power, video, camera control and tally to cameras
- Control pan, tilt, zoom and memory presets for up to 2 cameras.
- HDMI Input for computer presentations or adding lower 3rd titles with loop thru
- High-quality Neutrik locking ethernet ports for cameras
- Quadview 17" high-quality broadcast preview monitor
- Video effects including: Lumakey, PiP window, and Split Screen
- XLR audio input to embed audio from your mixer

The Majestic Staff manages videosystem

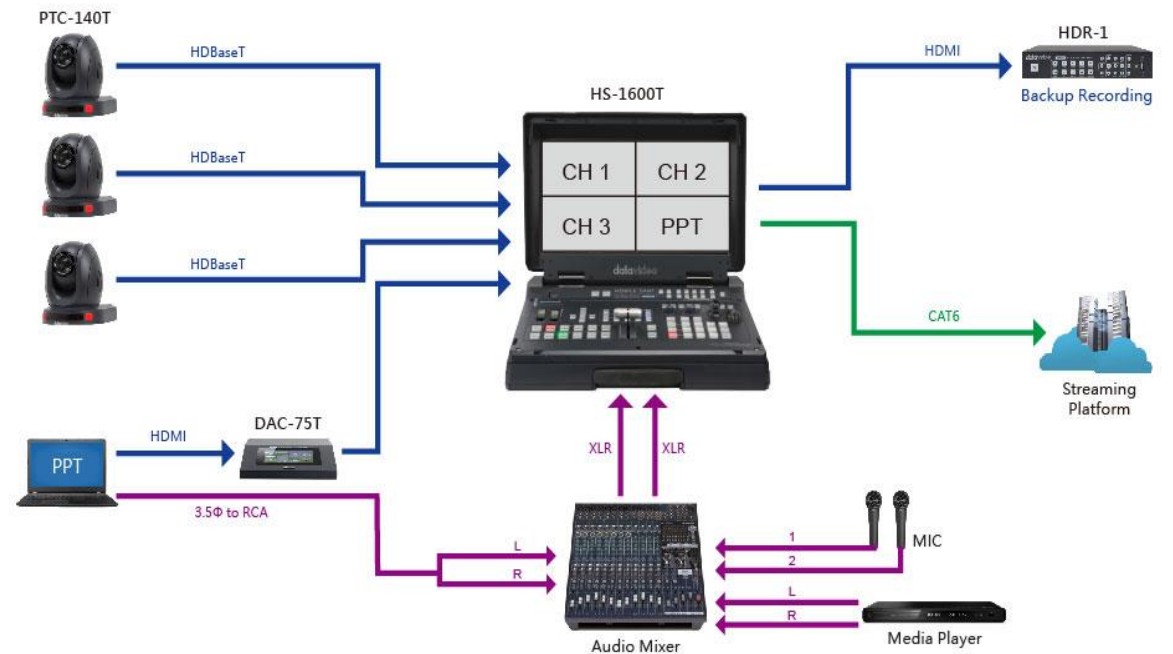

# HALL COUTTERAND

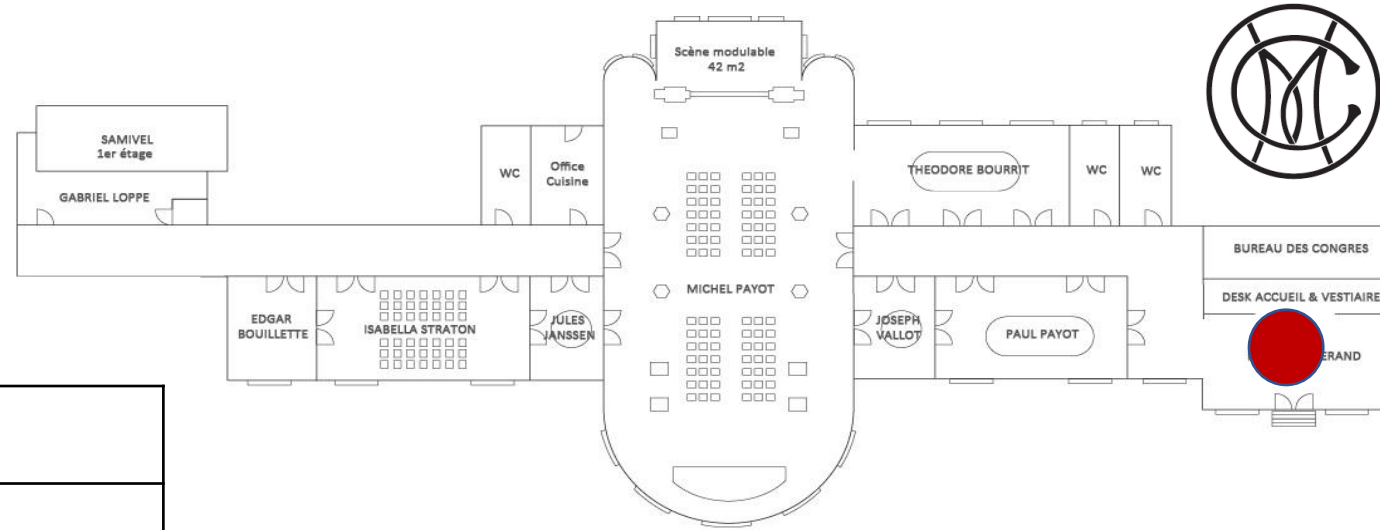

Capacity	Size
Stand up : 90 people	84 square meters : 13,4 x 6,3 x 6m (3,09 m under chandelier)

## Equipements

Welcome desk with storage, photocopier, wired Internet or high flow WIFI, bar

## Sound

Mobile sound machine

**Furniture** (on request) : high-bar tables with black lycra cover, 6 high stools, 8 red « toad » chairs, 2 black low tables

**Safety equipment** : 1 emergency exit, safety blocks



# Michel PAYOT ROOM

Capacity	Size	Front stage	Screen size
<b>Theatre</b> : 360 chairs	433 square meters (36 m2 stage) :  30,5 x 14,2 x 6,5m (5,46m under chandelier)	6 x 6 m	5,50 x 4m
<b>Classroom</b> : 140 chairs			
<b>Cocktail</b> : 500 pers.			

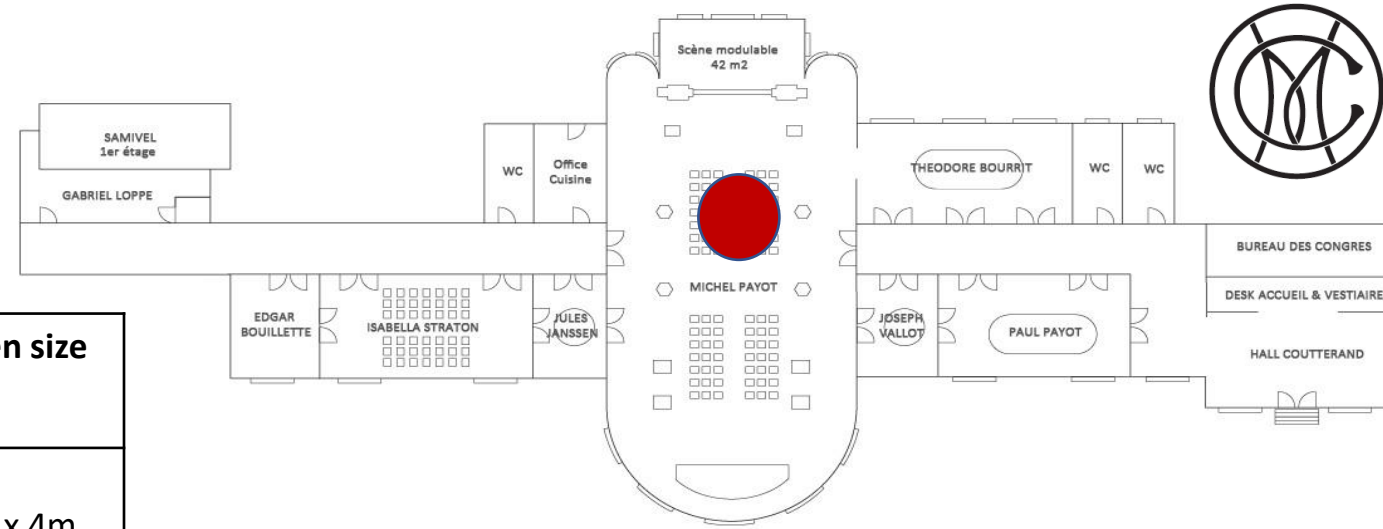

## Sound system equipment

1 mixing console ALLEN & HEATH QU16, 2 audio speakers "Line-Array" Martin Audio Omniline , 1 powerfull amplifier CREST AUDIO CC4000, 1 sound processor SHURE DFR22, 4 microphones SHURE SM58 + 4 receivers HF SENNHEISER EM 100, 4 microphones HF / helmet SENNHEISER SKM 100 , 4 micro cables XLR/XLR 5m, 2 micro cables XLR/XLR 10m, 4 microphone stands + integral boom K&M TKM210/9B, 2 microphones support K&M TKML232B, 1 audio multipair 40m with stagebox 16 inputs / 8 exits

## Visual equipement

1 light lecturn ETC SMARTFADE 2496, 8 scale lines 2,3 kW, 10 scale lines 2,3 kW stage, 12 spotlights DTS PAR64, 12 spotlights convex side ADB PC-101, 2 profile spotlifghts convex side ADB WARP12-30, 1 beamer Christie D12WU- H - 11000 lumens on lift pantographe motorized AUDIPACK, 1 back screen on stage Panasonic IPA TH-32EF1 – 32 pouces (80 cm), 1 source selector Pulse2H (inputs : 4 HDMI, 2VGA, 2 DVI, 2 SDI), 1 DVD player DENON DNV-110 ; 1 DVD player Tascam DV-01U, 1 laptop latitude 5580 DELL, laser pointer & remote control

# Michel PAYOT ROOM

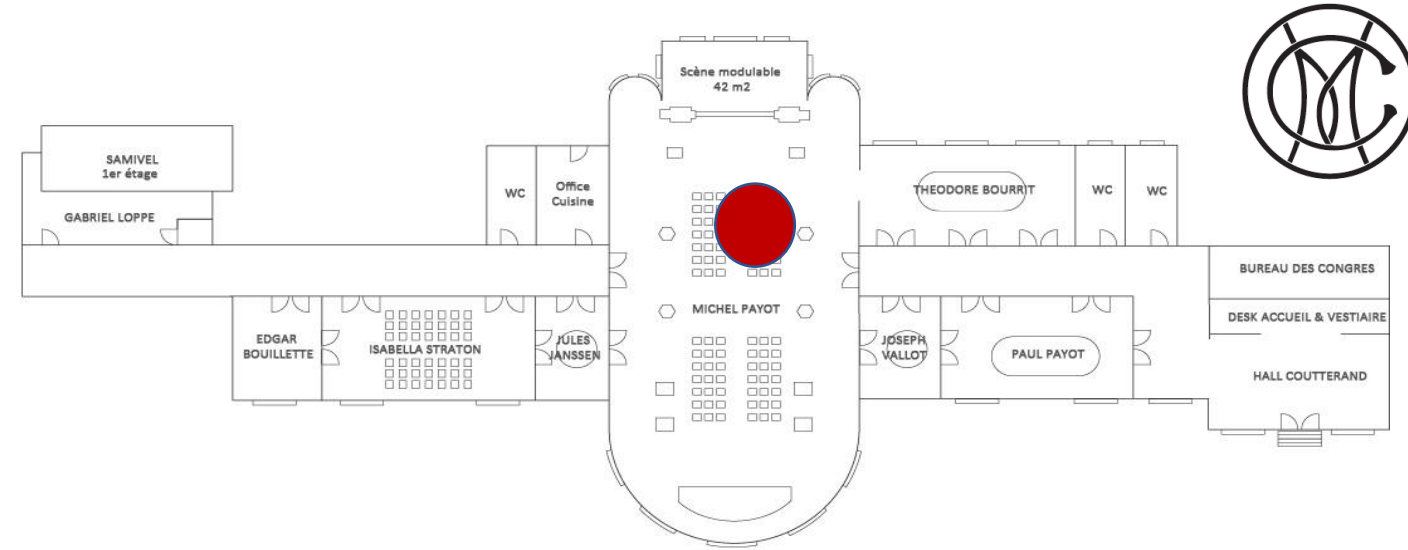

## Scenic feature

1 track lighting, 1 motorised curtain, 1 motorised screen, 2 aluminium beams, corridor curtains

On request : high-bar tables with black lycra cover, 6 high stools, 8 red « toad » chairs, 2 black low tables (hauteur 60 cm), 1 plexi lecturn with microphone, 1 classic lecturn with micro

**Safety equipment** : 1 smoke alarm and smoke extraction installation, smoke extract units, fire extinguisher, 2 emergency exits (terrace side), 2 emergency exits corridor side, safety lighting, safety blocks, fire valve

# PAUL PAYOT ROOM

Capacity	Size	Screen size
<b>Theatre</b> : 90 chairs	93 square meters : 12,5 x 7 x 4,5m (3 m under chandelier)	2 x 1,90 m
<b>U</b> : 40 chairs		
<b>Classroom</b> : 36 pers.		

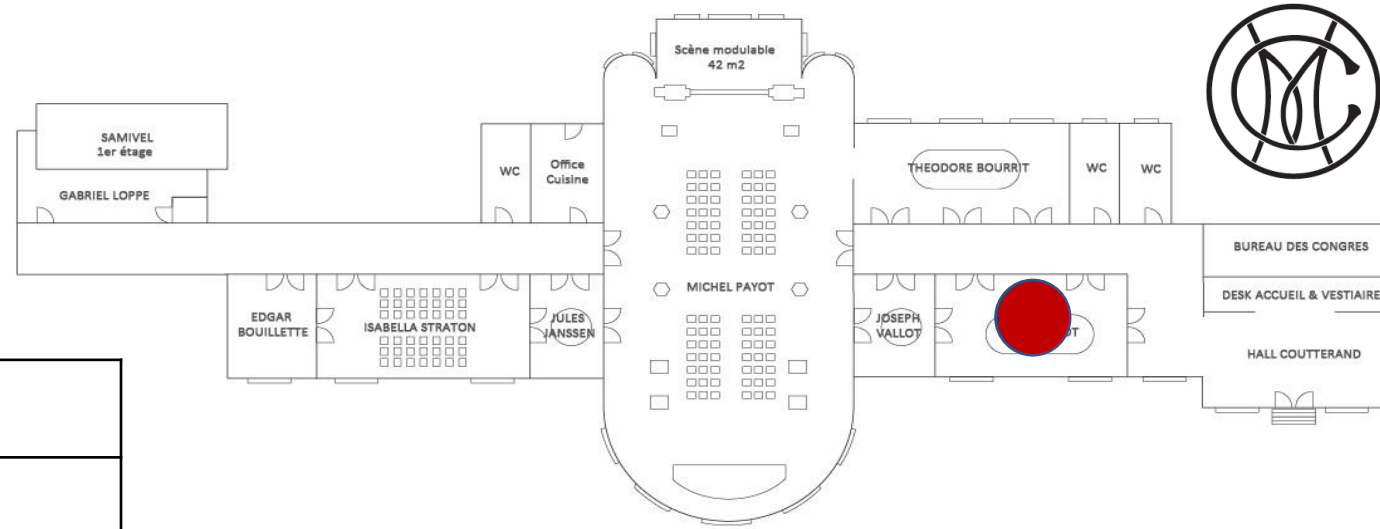

## Sound equipment

Mobile sound machine

## Visual equipment

Beamer Epson EB-W22 Tri-LCD 3000 lumens and mobile screen

**Feature** (on request) : high-bar tables with black lycra cover, 6 high stools, 8 red « toad » chairs, 2 black low tables (hauteur 60 cm), 1 plexi lecturn with microphone, 1 classic lecturn with micro

**Safety equipment** : 1 emergency exit, safety blocks

# THEODORE BOURRIT ROOM

Capacity	Size	Screen size
Theatre : 100 seats	98 square meters : 13,8 x 6,8 x 5,5 m	2 x 1,90 m
U : 42 seats		
Classroom : 36 pers.		

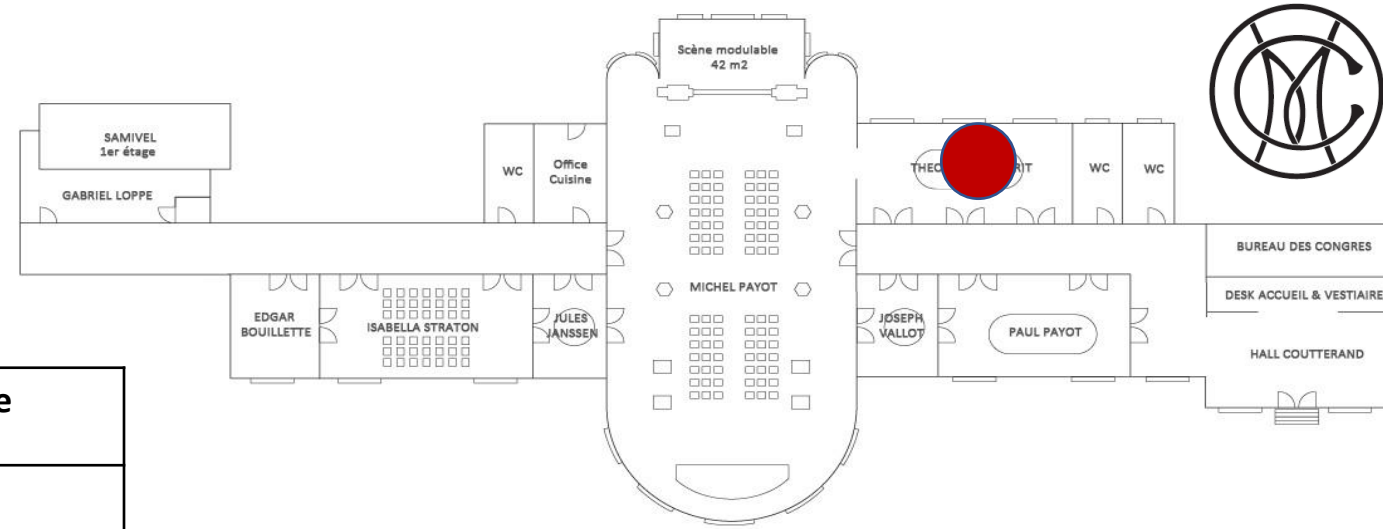

## Sound equipment

Mobile sound machine

## Visual equipment

Beamer Epson EB-W22 Tri-LCD 3000 lumens and mobile screen

**Feature** (on request) : high-bar tables with black lycra cover, 6 high stools, 8 red « toad » chairs, 2 black low tables (hauteur 60 cm), 1 plexi lecturn with microphone, 1 classic lecturn with micro

**Safety equipment** : 3 emergency exits, safety blocks

# JOSEPH VALLOT ROOM

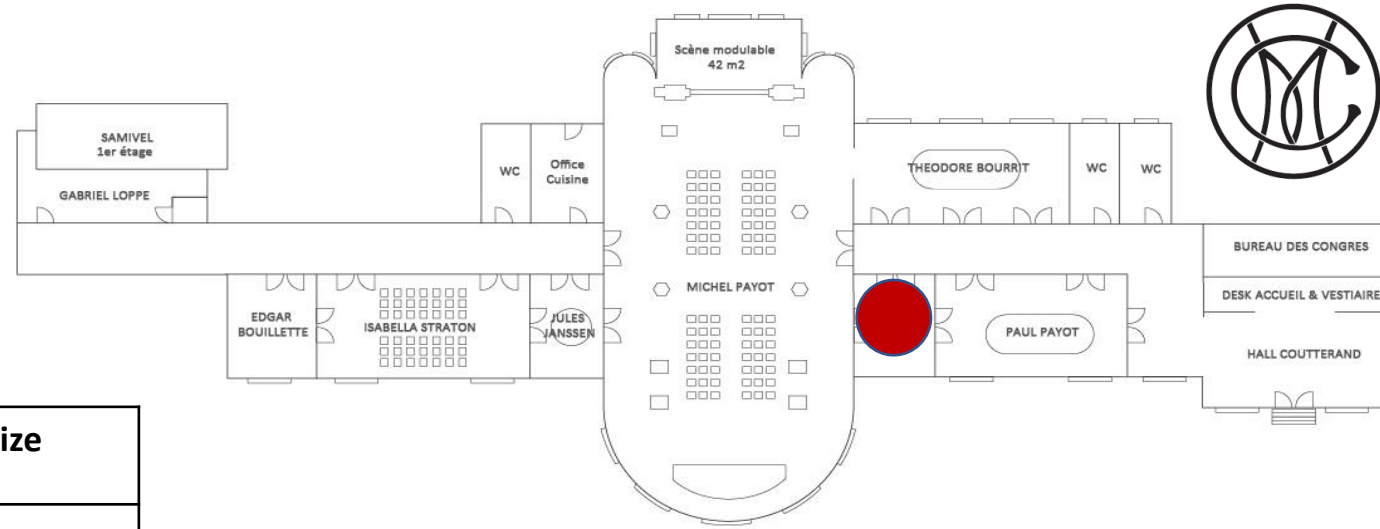

Capacity	Size	Screen size
<b>Theatre</b> : 28 seats	36 square meters : 7,2 x 4,8 x 4,5m (3 m under chandelier)	1,50 x 1,50 m
<b>U</b> : 16 seats		
<b>Classroom</b> : 18 pers.		

## Visual equipment

Beamer Epson EB-W22 Tri-LCD 3000 lumens and mobile screen

**Feature** (on request) : high-bar tables with black lycra cover, 6 high stools, 8 red « toad » chairs, 2 black low tables (hauteur 60 cm), 1 plexi lecturn with microphone, 1 classic lecturn with micro

**Safety equipment** : 2 emergency exits, safety blocks

# JULES JANSSEN ROOM

Capacity	Size	Screen size
Theatre : 28 seats	35 square meters : 7,2 x 4,2 x 4,5m (2,88 m under chandelier)	1,50 x 1,50 m
U : 16 seats		
Classroom : 18 pers.		

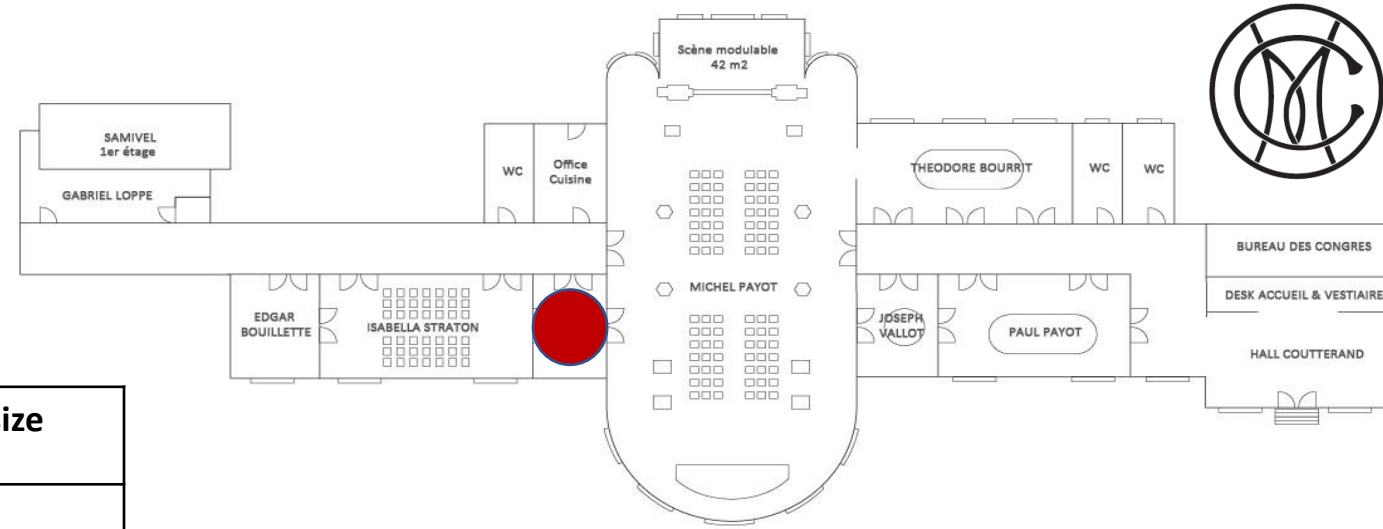

## Visual equipment

Beamer Epson EB-W22 Tri-LCD 3000 lumens and mobile screen

**Feature** (on request) : high-bar tables with black lycra cover, 6 high stools, 8 red « toad » chairs, 2 black low tables (hauteur 60 cm), 1 plexi lecturn with microphone, 1 classic lecturn with micro

**Safety equipment** : 2 emergency exits, safety blocks

# ISABELLA STRATON ROOM

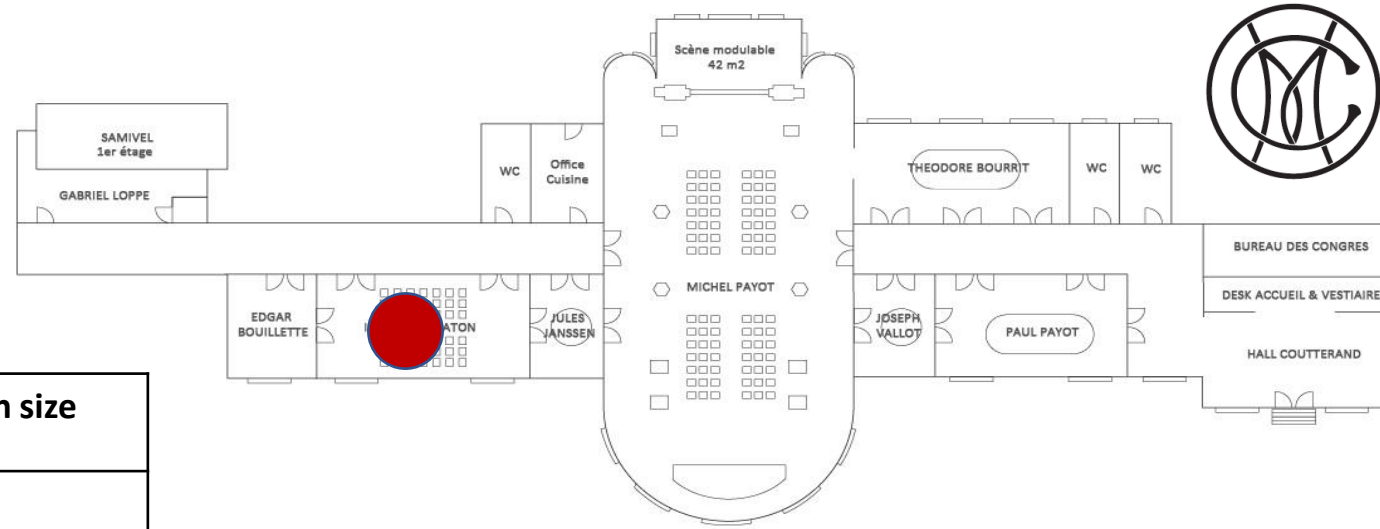

Capacity	Size	Screen size
<b>Theatre</b> : 100 seats	97 square meters : 12,5 x 7 x 6,40 m (4,55 m under chandelier)	2 x 1,90 m
<b>U</b> : 40 seats		
<b>Classroom</b> : 48 pers.		

## Sound equipment

Mobile sound machine

## Visual equipment

Beamer Epson EB-W22 Tri-LCD 3000 lumens and mobile screen

**Feature** (on request) : high-bar tables with black lycra cover, 6 high stools, 8 red « toad » chairs, 2 black low tables (hauteur 60 cm), 1 plexi lecturn with microphone, 1 classic lecturn with micro

**Safety equipment** : 2 emergency exits, safety blocks

# EDGARD BOUILLETTE ROOM

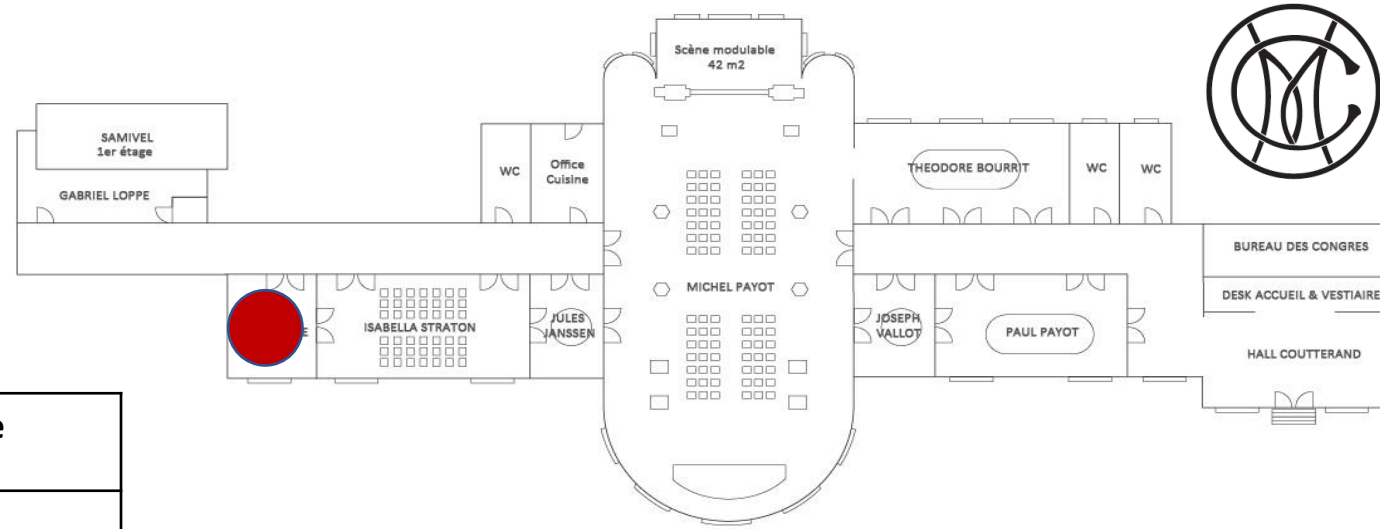

Capacity	Size	Screen size
<b>Théâtre</b> : 28 seats	34 square meters : 7,2 x 5 x 4,5m	1,50 x 1,50 m
<b>U</b> : 16 seats		
<b>Ecole</b> : 18 pers.		

## Visual equipment

Beamer Epson EB-W22 Tri-LCD 3000 lumens and mobile screen

**Feature** (on request) : high-bar tables with black lycra cover, 6 high stools, 8 red « toad » chairs, 2 black low tables (hauteur 60 cm), 1 plexi lecturn with microphone, 1 classic lecturn with micro

**Safety equipment** : 2 emergency exits, safety blocks



# GABRIEL LOPPÉ ROOM

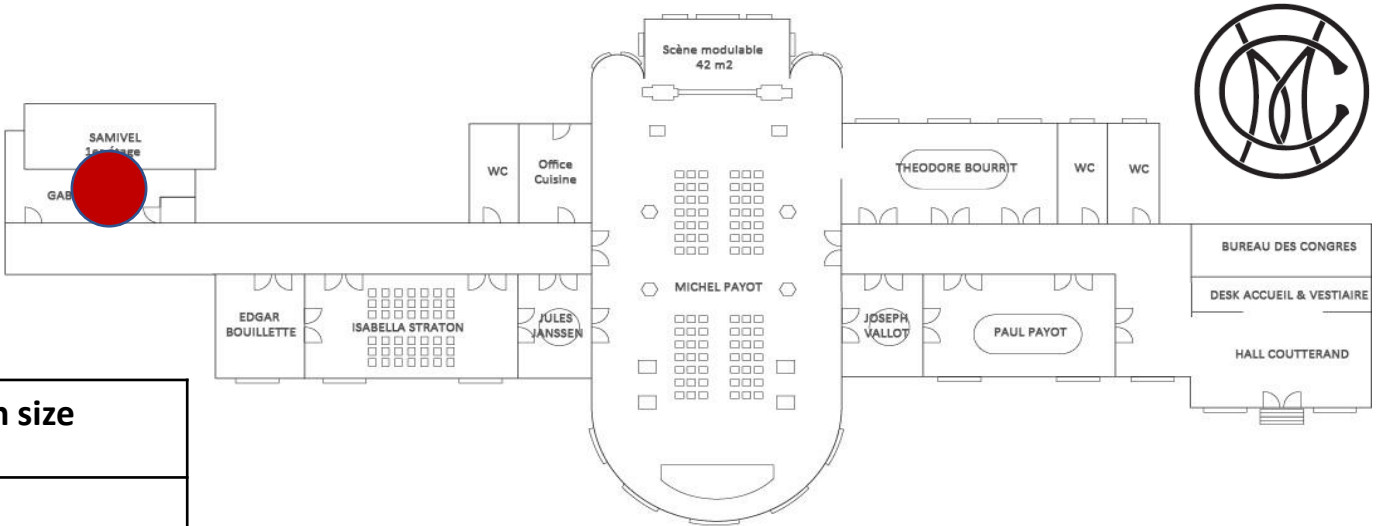

Capacity	Size	Screen size
<b>Theatre</b> : 12 seats	25 square meters : 4,7 x 5,2 x 2,98 m	Projection on white wall
<b>U</b> : 9 seats		
<b>Classroom</b> : 12 pers.		

**Visual equipment** (on request)  
 Beamer Mitsubishi 2000 lumens

**Safety equipment** : 1 emergency exit, safety blocks

# SAMIVEL ROOM

Capacity	Size	Screen size
<b>Theatre</b> : 19 seats	49 square meters : 9,4 x 5,2 x 2,5 m	Projection on white wall
<b>U</b> : 15 seats		
<b>Ecole</b> : 18 pers.		

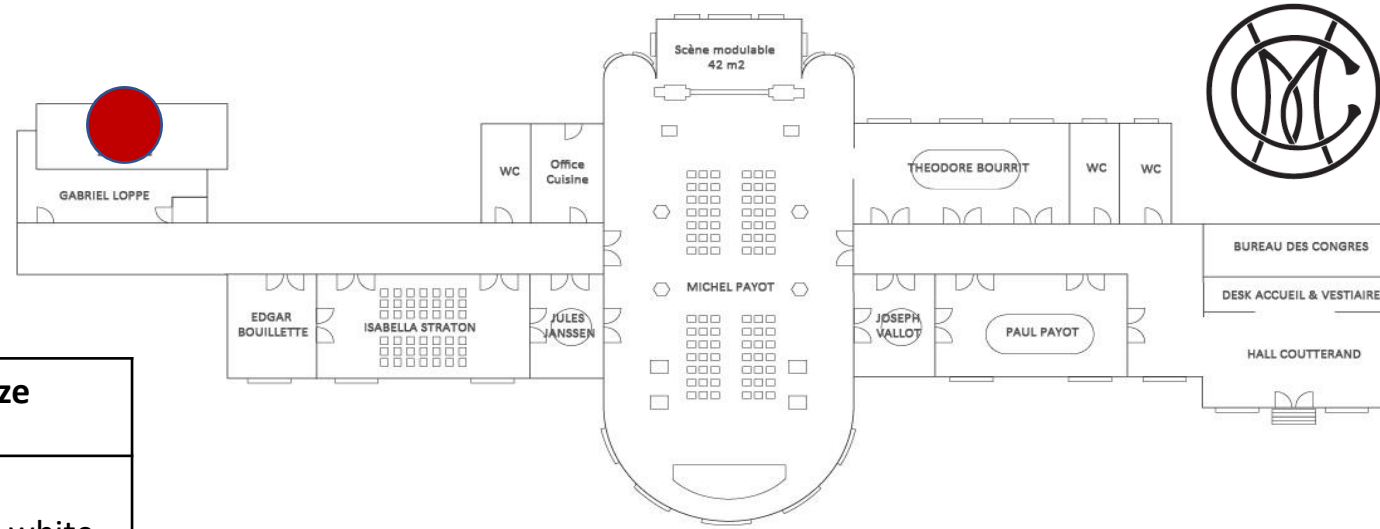

## Visual equipment (on request)

Beamer Mitsubishi 2000 lumens

**Safety equipment** : 1 emergency exit, safety blocks



# DETAILED ROOMS MAPS

# HALL COUTTERAND

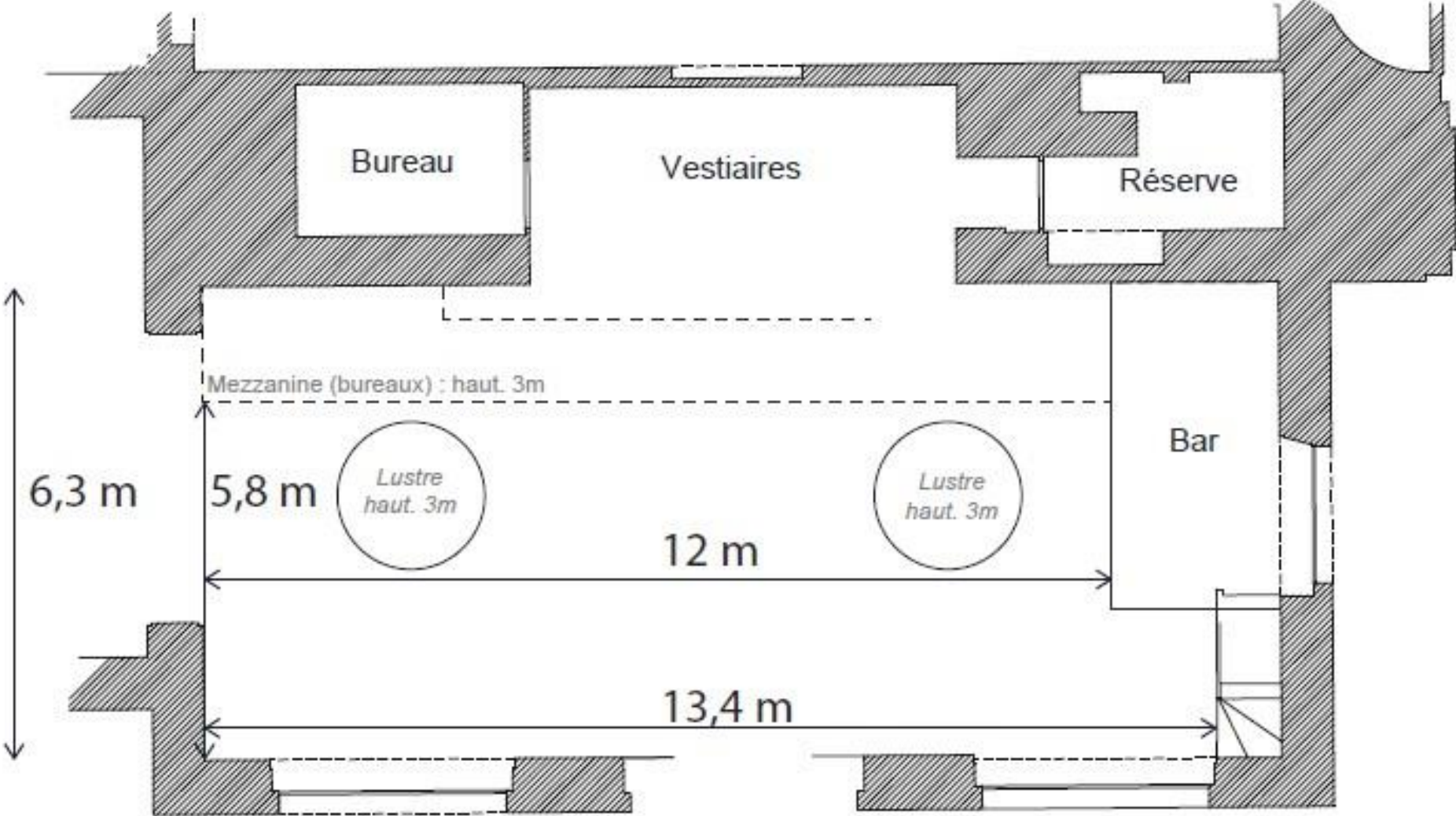



# Salle PAUL PAYOT

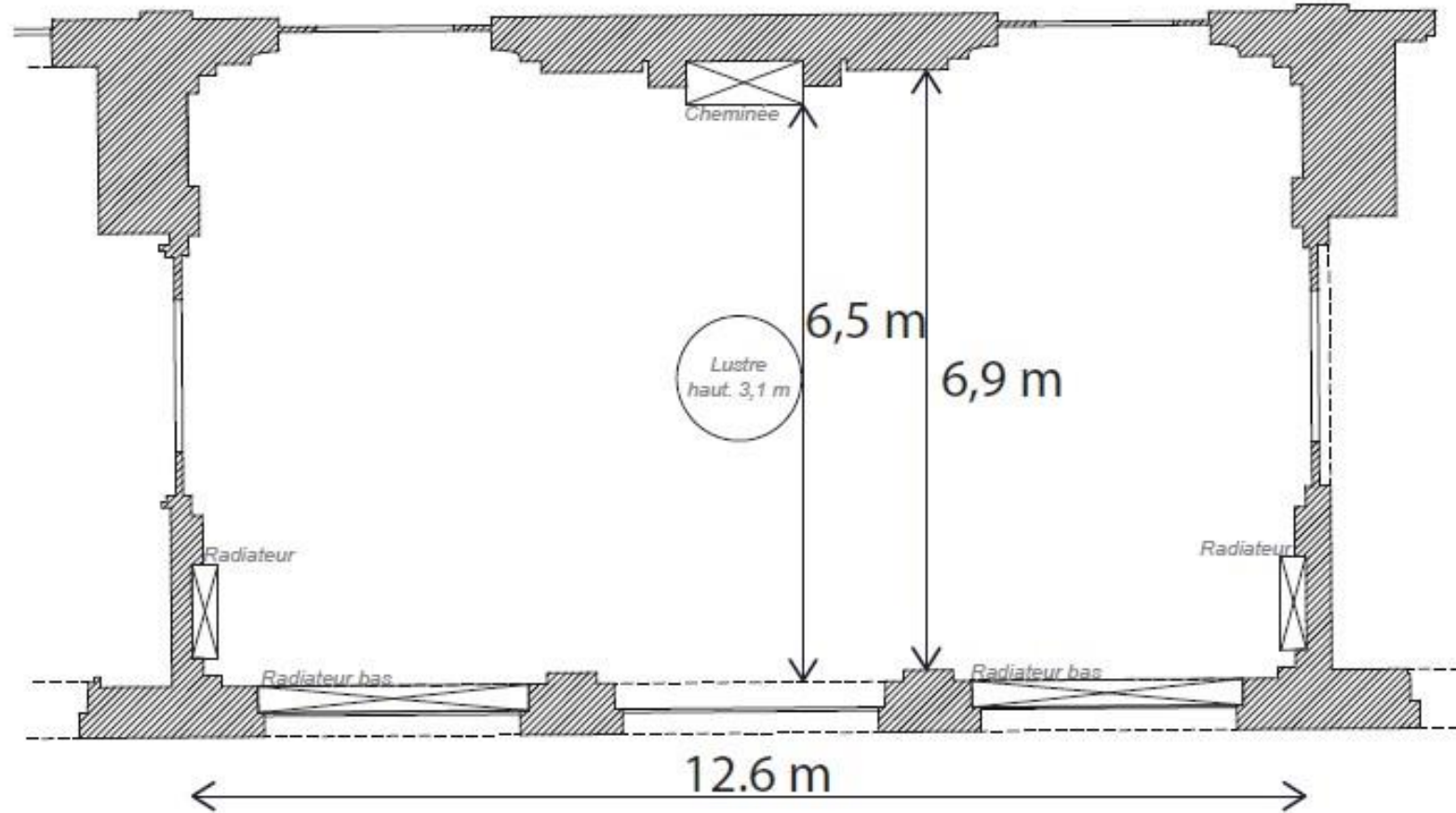

# Salle THEODORE BOURRIT

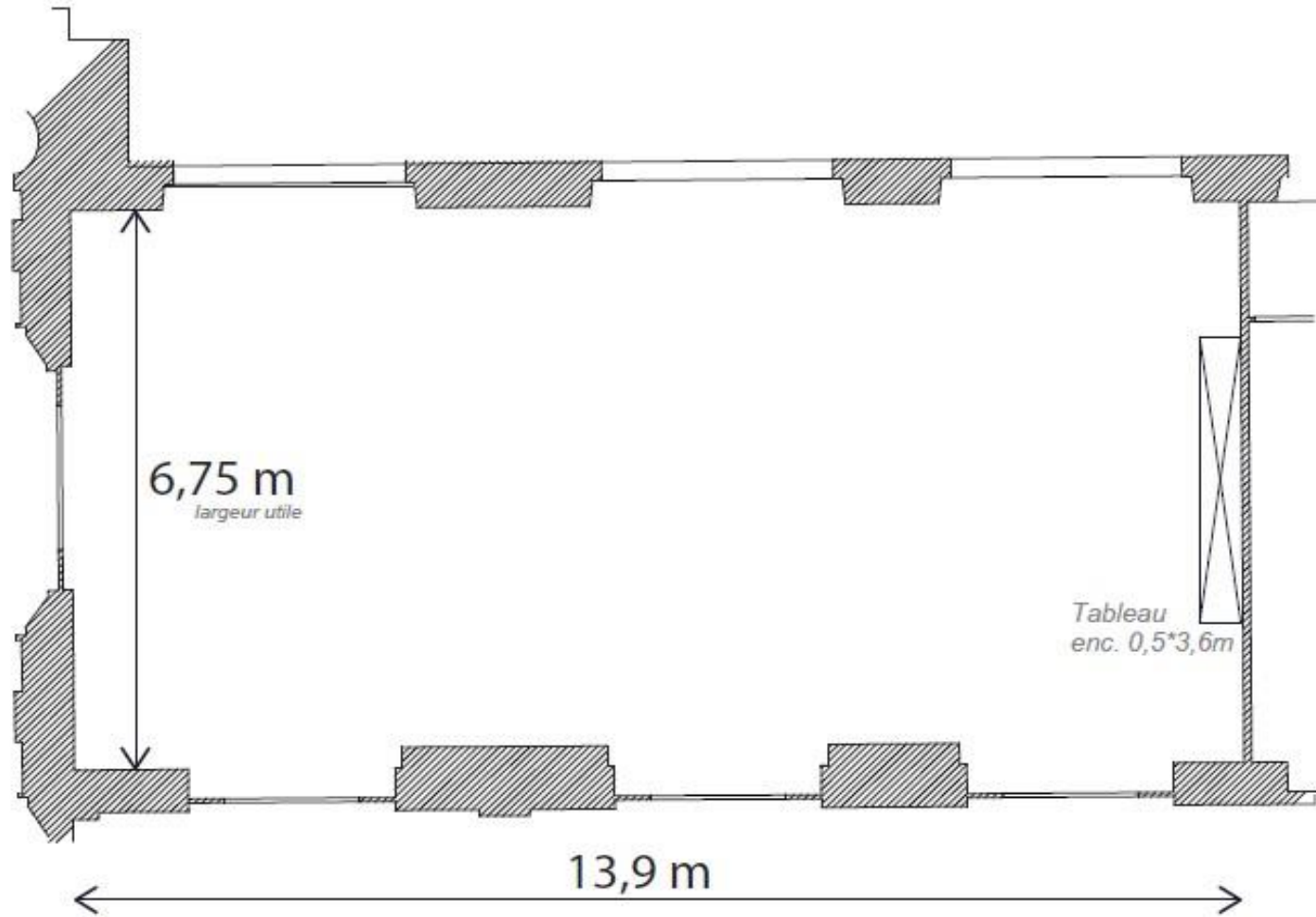



# Salle JOSEPH VALLOT

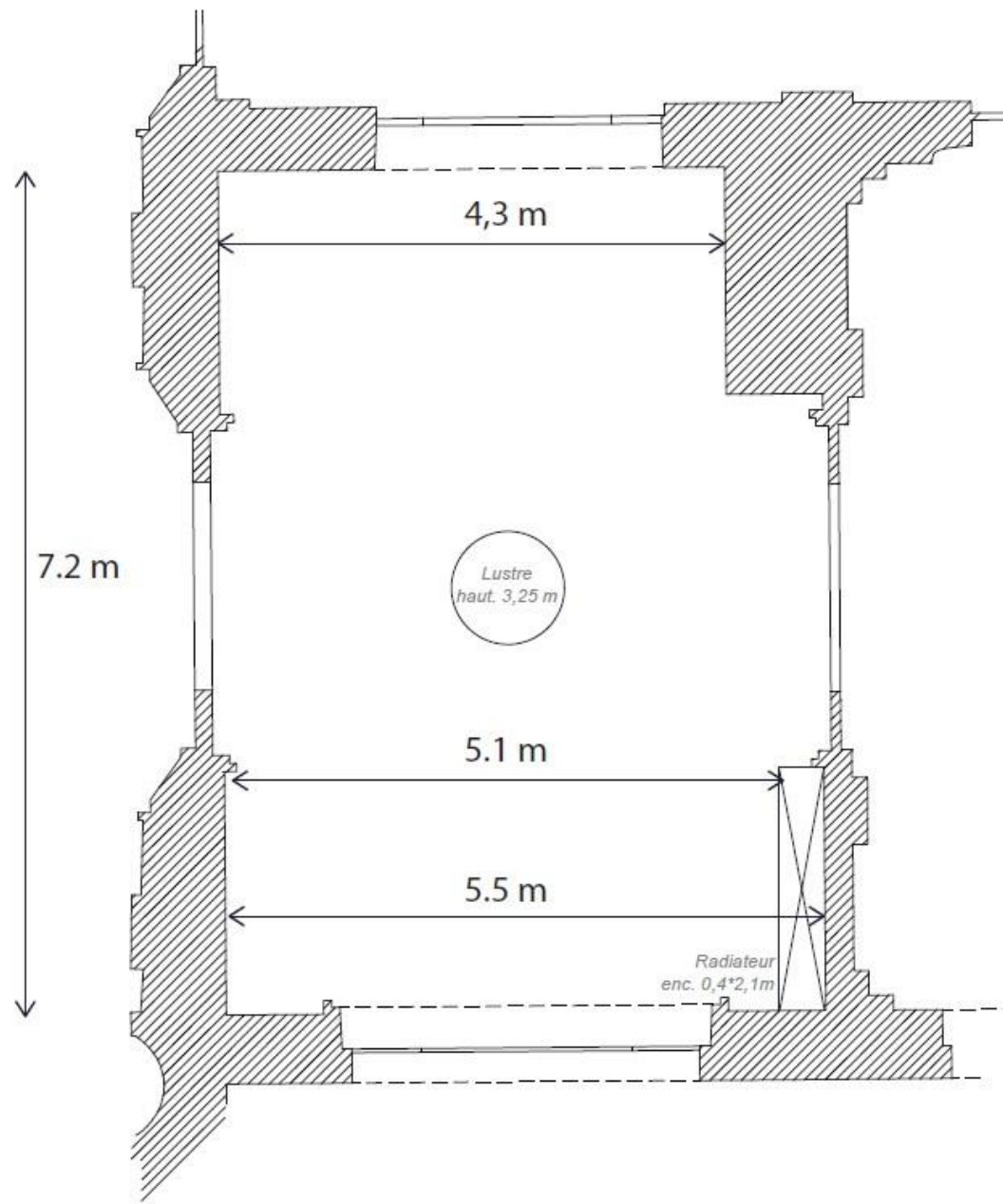
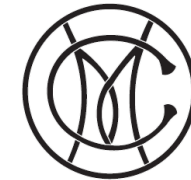



# Salle JULES JANSSEN

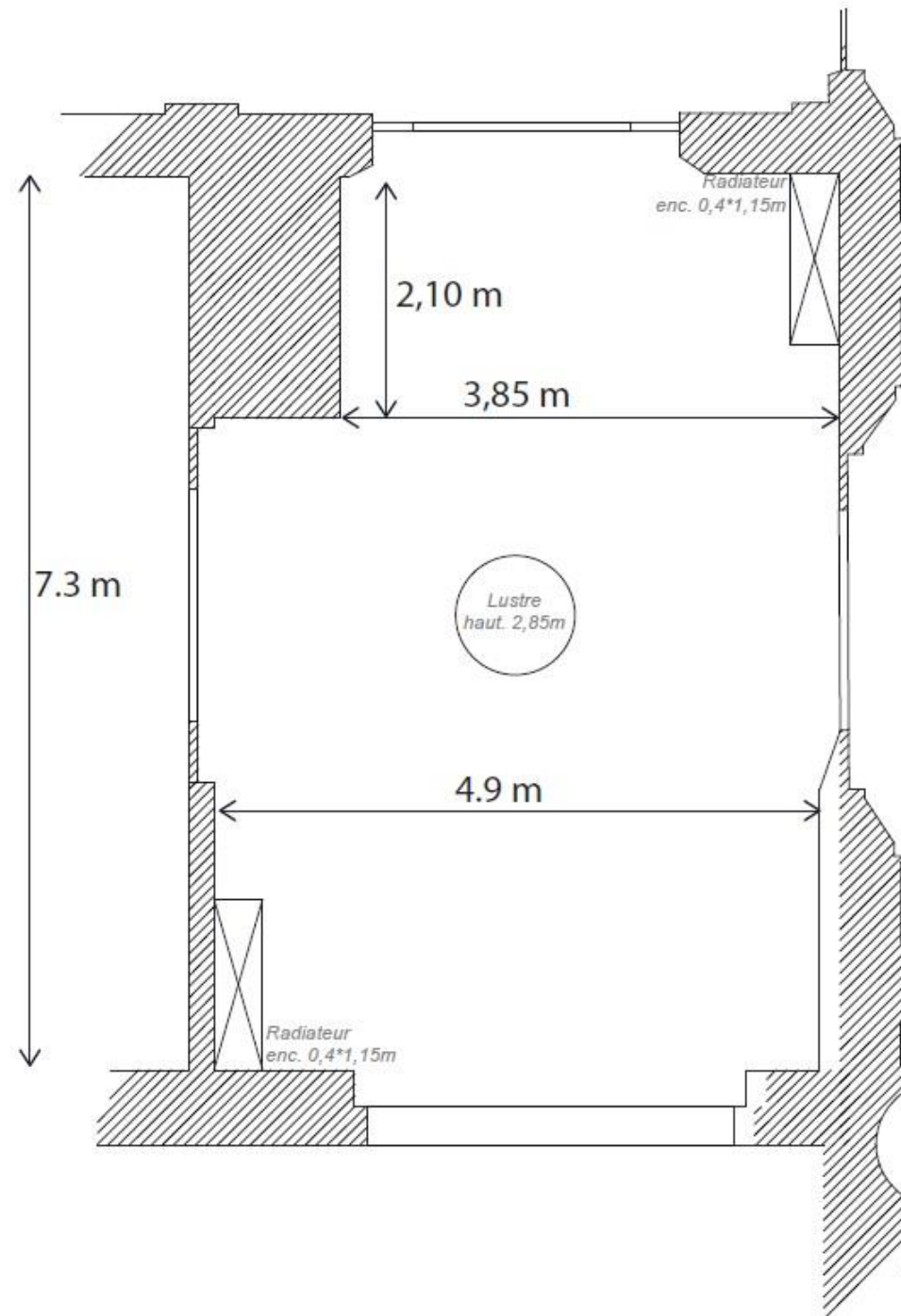

# Salle ISABELLA STRATON

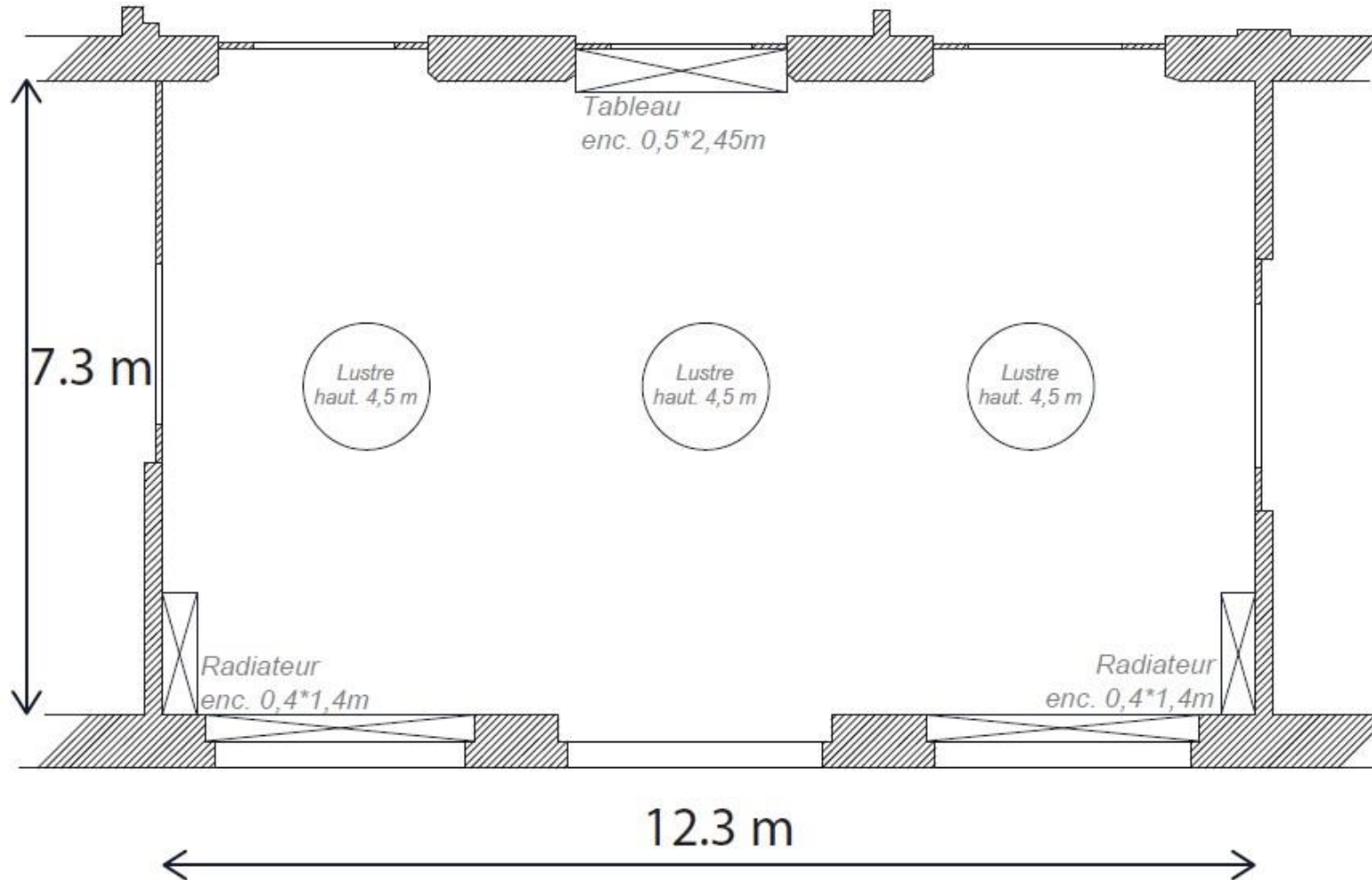

# Salle EDGARD BOUILLE

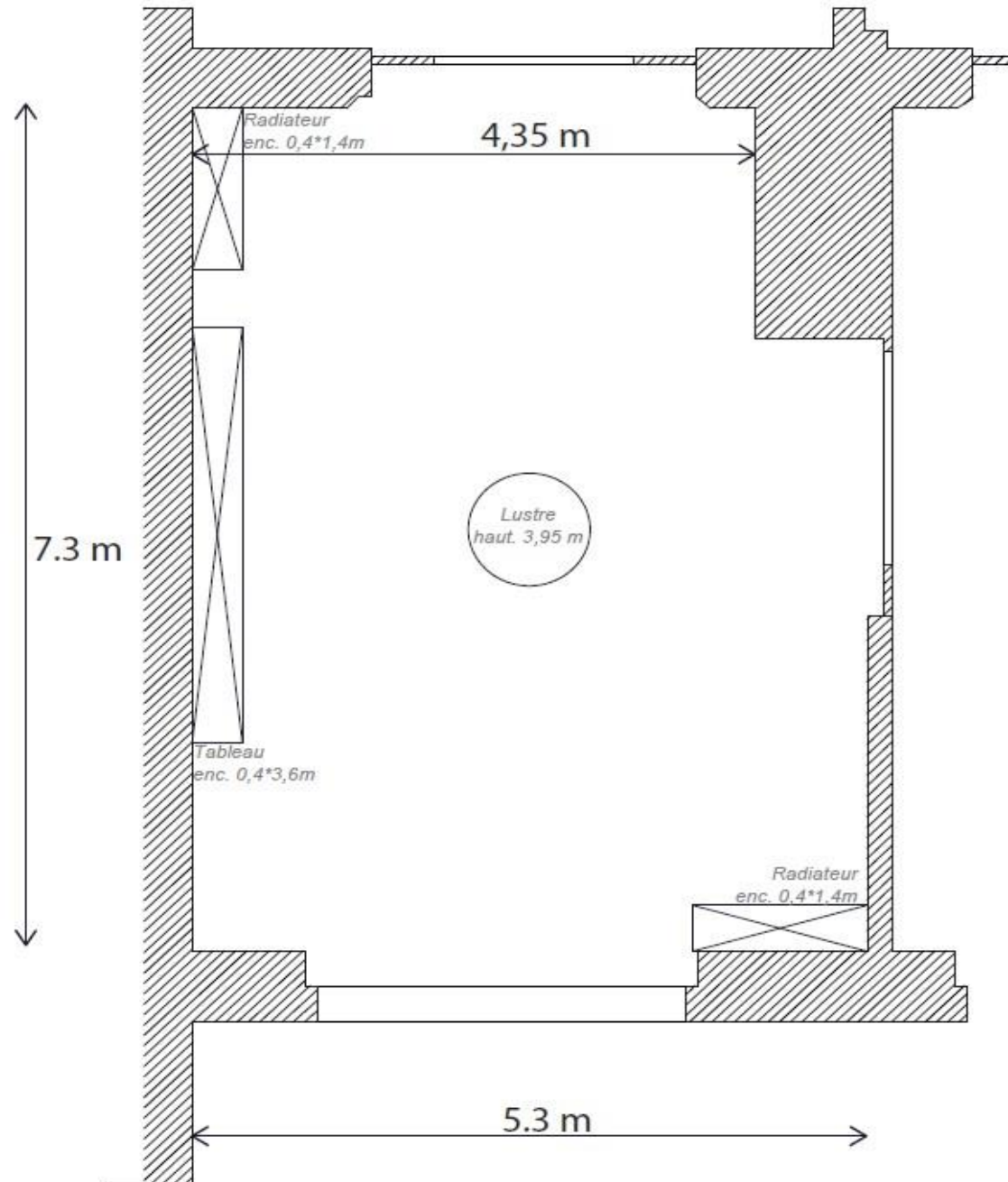

# Salle GABRIEL LOPPÉ

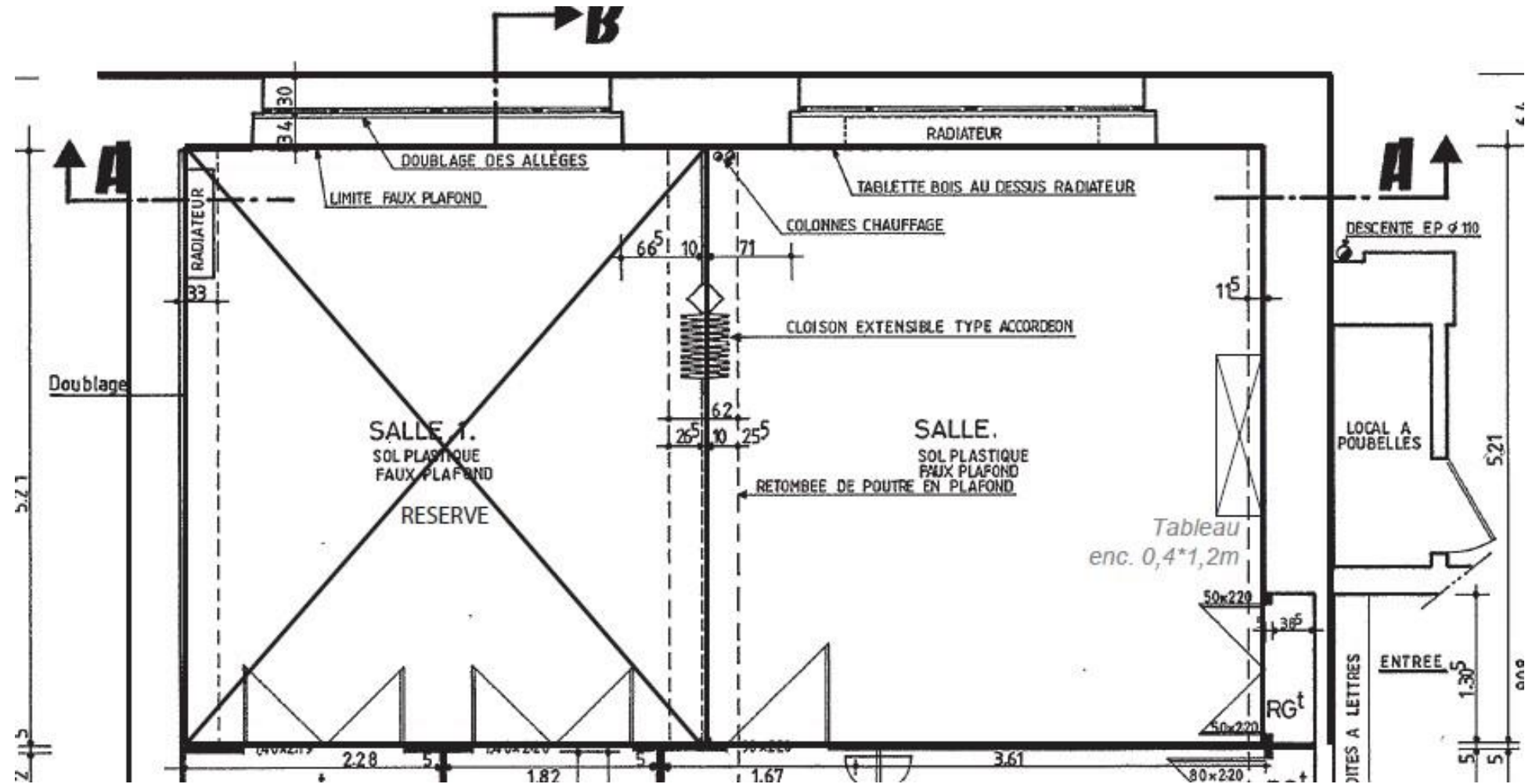

# Salle SAMIVEL

